

## METRIC BITE TYPE FITTINGS

### GE-B - STRAIGHT MALE STUD COUPLING

Taper Male Thread G - BSPT

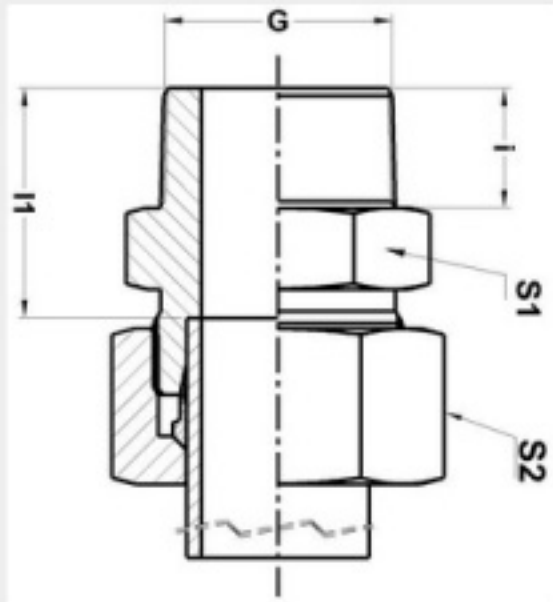

**ORIENT ENGINEERING WORKS**

Part No.	Series	Tube OD	l1	i	S2	S1	G
GE 06 LB	Light-250 Bar	6	18	8	14	12	G 1/8
GE 08 LB	Light-250 Bar	8	22	12	17	17	G 1/4
GE 10 LB	Light-250 Bar	10	23	12	19	17	G 1/4
GE 12 LB	Light-250 Bar	12	24.5	12	22	19	G 3/8
GE 12 LB	Light-250 Bar	12	24	12	22	19	G 1/4
GE 12 LB	Light-250 Bar	12	24	14	22	24	G 1/2
GE 15 LB	Light-250 Bar	15	28	14	27	24	G 1/2
GE 15 LB	Light-250 Bar	15	25.5	12	27	24	G 3/8
GE 18 LB	Light-160 Bar	18	28.5	14	32	27	G 1/2
GE 22 LB	Light-160 Bar	22	32.5	16	36	32	G 3/4
GE 28 LB	Light-100 Bar	28	39.5	18	41	41	G 1
GE 35 LB	Light-100 Bar	35	40.5	20	50	50	G 1 1/4
GE 42 LB	Light-100 Bar	42	43	22	60	55	G 1 1/2
GE 06 SB	Heavy-630 Bar	6	25	12	17	19	G 1/4
GE 08 SB	Heavy-630 Bar	8	27	12	19	19	G 1/4